



Whernside Drive, Stevenage

CHANDLERS

16 Whernside Drive

Stevenage, SG1 6HW
Guide Price £230,000



2 Bedrooms



2 Bathrooms



1 Reception Rooms



EPC Rating Band C

A well presented ground floor two bedroom purpose build apartment with allocated parking. Located within Great Ashby a desirable modern development to to the North of Stevenage and with a range of local facilities as well as access to Stevenage.

Accommodation comprises entrance hall with door entry system, sitting / dining room, fitted kitchen, main bedroom with ensuite, further bedroom and family bathroom.

(EPC Rating C - North Hertfordshire Council - Council Tax Band B - 999 Year lease from 01/7/2006, Ground Rent £165.68 PA - Service Charge £1678.54 PA - Buildings Insurance Included in Service Charge)

Please Note – the details provided relating to the lease including have been supplied by the vendor therefore, Chandelers take no responsibility for the accuracy of the information provided as we have not seen a copy of the original lease.

- Two Bedroom ground floor apartment
 - Allocated parking
 - Popular location
 - Hallway
 - Sitting / Dining Room
 - Fitted Kitchen
 - Main bedroom with ensuite
 - Family Bathroom
 - Long Lease





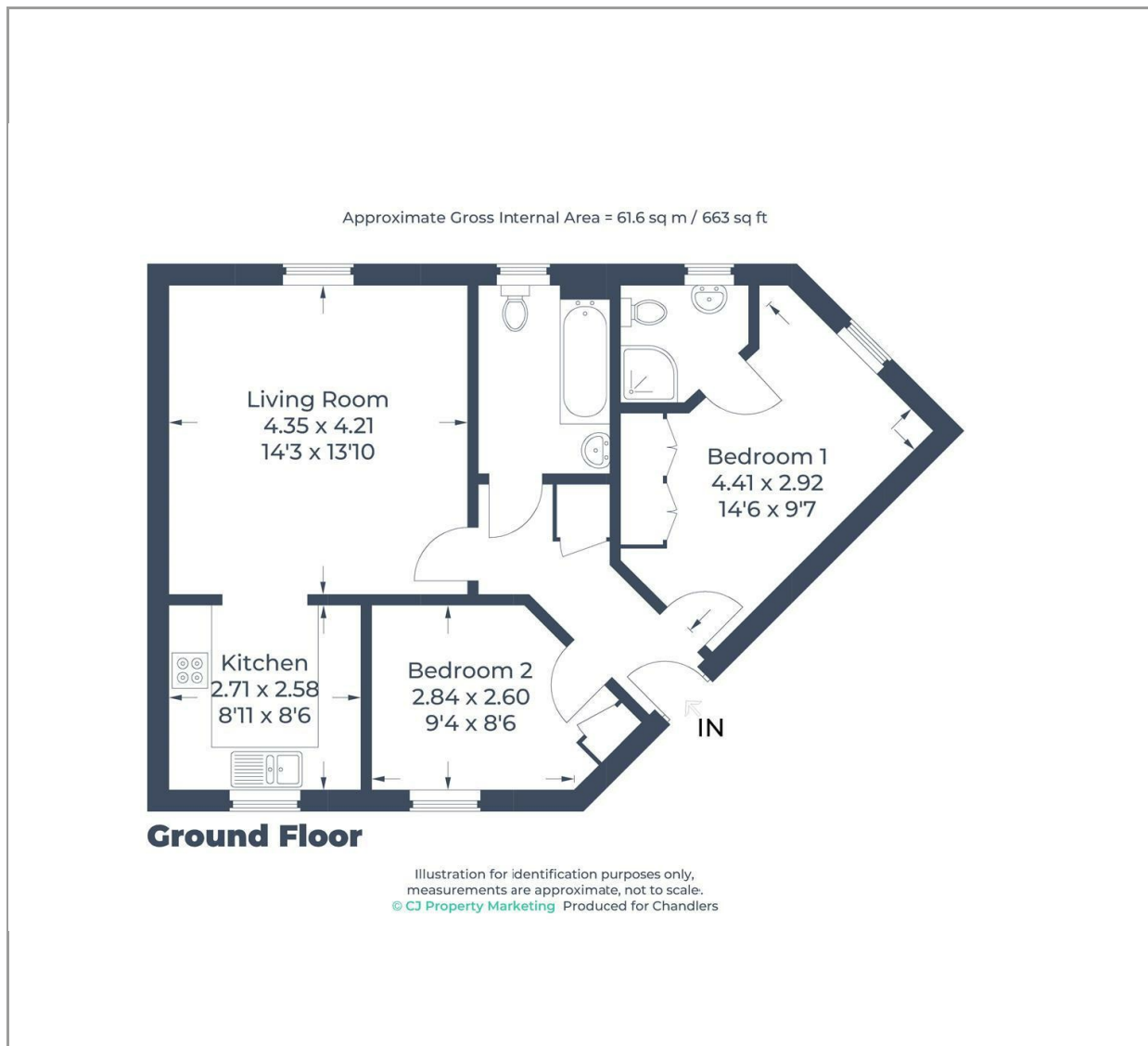

Disclaimer

While we believe the details provided to be correct, we do not guarantee their accuracy. Prospective buyers should verify all information independently before making any decisions. No responsibility is taken for any errors, omissions, or misstatements.

Additional/Material Information

- Local Authority is North Hertfordshire
- Council tax Band B
- Tenure – Leasehold
- Mains Gas, Water, Electricity

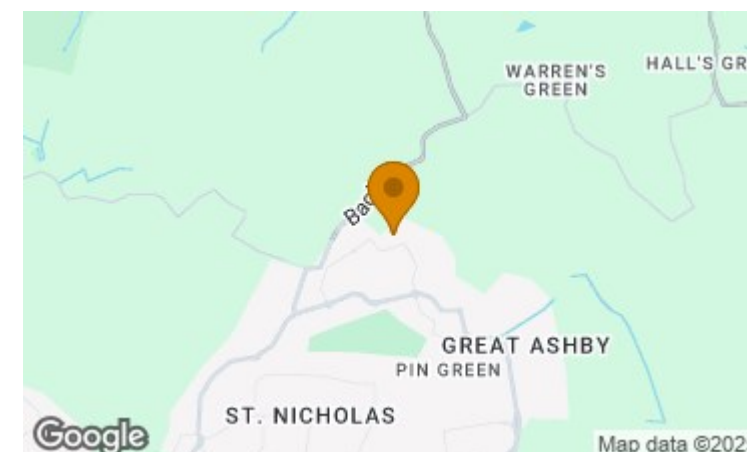

Energy Efficiency Rating		
	Current	Potential
Very energy efficient - lower running costs		
(92 plus) A		
(81-91) B		
(69-80) C		
(55-68) D	71	75
(39-54) E		
(21-38) F		
(1-20) G		
Not energy efficient - higher running costs		
England & Wales	EU Directive 2002/91/EC	